

# State of Wyoming Corner Record

(IN COMPLIANCE WITH THE CORNER PERPETUATION AND FILING ACT, WYOMING STATUTES, 1977 SECTION 33-29-140, ET. SEQ., AND THE RULES AND REGULATIONS OF THE BOARD OF PROFESSIONAL ENGINEERS AND PROFESSIONAL LAND SURVEYORS)

REVERSE SIDE OF THIS FORM MAY BE USED IF MORE SPACE IS NEEDED.

RECORD OF ORIGINAL SURVEY AND CITATION OF SOURCE OF HISTORICAL INFORMATION (IF CORNER IS LOST OR OBLITERATED). DESCRIPTION OF CORNER MONUMENTATION EVIDENCE FOUND AND/OR MONUMENT AND ACCESSORIES ESTABLISHED TO PERPETUATE THE LOCATION OF THIS CORNER. SKETCH OF RELATIVE MONUMENT, ACCESSORIES, AND REFERENCE POINTS WITH COURSE AND DISTANCE TO ADJACENT CORNER(S) (IF DETERMINED IN THIS SURVEY). METHOD AND RATIONALE FOR REESTABLISHMENT OF LOST OR OBLITERATED CORNER.

FOUND STONE 8"X7" 8" ABOVE GROUND  
 1<sup>st</sup> SOUTH OF EAST-WEST FENCE  
 CLEARLY MARKED ON NORTH FACE  
 LARGE FLAT STONE ON EDGE 1<sup>st</sup> SOUTH OF CORNER

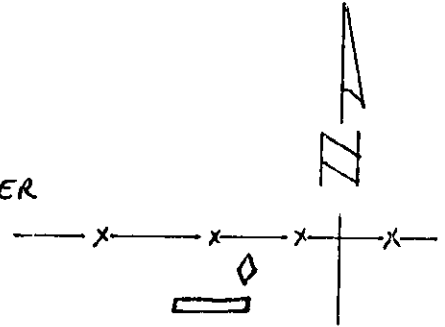
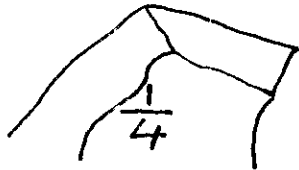

## MONUMENT LOCATION

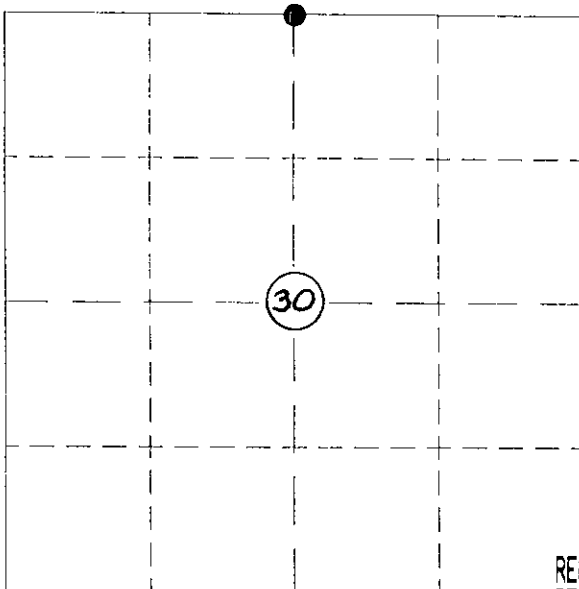

See sketch on back



RECORDED 11/24/2004 AT 12:10 PM REC# 403333 BK# 1850 PG# 151  
 DEBRA K. LATHROP, CLERK OF LARAMIE COUNTY, WY PAGE 1 OF 2

DATE OF FIELD WORK: 11/11/04

OFFICE REFERENCE: 04209

## CROSS INDEX PLAT

FIRM/AGENCY, ADDRESS

THIS CORNER RECORD WAS PREPARED BY ME OR UNDER MY DIRECTION AND SUPERVISION.

	1	2	3	4	5	6	7	8	9	10	11	12	13	14	15	16	17	18	19	20	21	22	23	24	25	
A	+	+	+	+	+	+	+	+	+	+	+	+	+	+	+	+	+	+	+	+	+	+	+	+	+	A
B	+	+	+	+	+	+	+	+	+	+	+	+	+	+	+	+	+	+	+	+	+	+	+	+	+	B
C	+	6	+	5	+	4	+	3	+	2	+	1	+	+	+	+	+	+	+	+	+	+	+	+	+	C
D	+	+	+	+	+	+	+	+	+	+	+	+	+	+	+	+	+	+	+	+	+	+	+	+	+	D
E	+	+	+	+	+	+	+	+	+	+	+	+	+	+	+	+	+	+	+	+	+	+	+	+	+	E
F	+	+	+	+	+	+	+	+	+	+	+	+	+	+	+	+	+	+	+	+	+	+	+	+	+	F
G	+	7	+	8	+	9	+	10	+	11	+	12	+	+	+	+	+	+	+	+	+	+	+	+	+	G
H	+	+	+	+	+	+	+	+	+	+	+	+	+	+	+	+	+	+	+	+	+	+	+	+	+	H
J	+	+	+	+	+	+	+	+	+	+	+	+	+	+	+	+	+	+	+	+	+	+	+	+	+	J
K	+	+	+	+	+	+	+	+	+	+	+	+	+	+	+	+	+	+	+	+	+	+	+	+	+	K
L	+	18	+	17	+	16	+	15	+	14	+	13	+	+	+	+	+	+	+	+	+	+	+	+	+	L
M	+	+	+	+	+	+	+	+	+	+	+	+	+	+	+	+	+	+	+	+	+	+	+	+	+	M
N	+	+	+	+	+	+	+	+	+	+	+	+	+	+	+	+	+	+	+	+	+	+	+	+	+	N
O	+	+	+	+	+	+	+	+	+	+	+	+	+	+	+	+	+	+	+	+	+	+	+	+	+	O
P	+	19	+	20	+	21	+	22	+	23	+	24	+	+	+	+	+	+	+	+	+	+	+	+	+	P
Q	+	+	+	+	+	+	+	+	+	+	+	+	+	+	+	+	+	+	+	+	+	+	+	+	+	Q
R	+	+	+	+	+	+	+	+	+	+	+	+	+	+	+	+	+	+	+	+	+	+	+	+	+	R
S	+	+	+	+	+	+	+	+	+	+	+	+	+	+	+	+	+	+	+	+	+	+	+	+	+	S
T	+	30	+	29	+	28	+	27	+	26	+	25	+	+	+	+	+	+	+	+	+	+	+	+	+	T
U	+	+	+	+	+	+	+	+	+	+	+	+	+	+	+	+	+	+	+	+	+	+	+	+	+	U
V	+	+	+	+	+	+	+	+	+	+	+	+	+	+	+	+	+	+	+	+	+	+	+	+	+	V
W	+	+	+	+	+	+	+	+	+	+	+	+	+	+	+	+	+	+	+	+	+	+	+	+	+	W
X	+	31	+	32	+	33	+	34	+	35	+	36	+	+	+	+	+	+	+	+	+	+	+	+	+	X
Y	+	+	+	+	+	+	+	+	+	+	+	+	+	+	+	+	+	+	+	+	+	+	+	+	+	Y
Z	+	+	+	+	+	+	+	+	+	+	+	+	+	+	+	+	+	+	+	+	+	+	+	+	+	Z
	1	2	3	4	5	6	7	8	9	10	11	12	13	14	15	16	17	18	19	20	21	22	23	24	25	

COFFEY & ASSOCIATES, L.L.C.  
 903 GRAND AVENUE  
 LARAMIE, WYOMING 82070  
 TELEPHONE NUMBER: (307)742-7425

SEAL & SIGNATURE



CORNER NAME: N 1/4 Cor Sec 30, T13N, R 70W, 6<sup>th</sup> PM

COUNTY: Albany/Laramie

CROSS-INDEX NUMBER: R-3

